

**DESIGN PROFESSIONALS GENERAL NOTES IF APPLICABLE**

**NATURAL RESOURCE PROFESSIONAL CONTACT INFO**

**COLUMBUS REC. AND PARKS DEPT. STANDARD PLAN NOTE**

PRIOR TO SUBMISSION OF FINAL SITE COMPLIANCE PLAN, ANY ENTITY REQUESTING NON-PARK USE/DEVELOPMENT MUST SUBMIT A NON-PARK USE OF PARKLAND (NPUP) APPLICATION TO CRPD PROPERTY MANAGER TINA MOHN AT TMMOHN@COLUMBUS.GOV TO SECURE A PERMIT TO ENTER CRPD PROPERTY. THE CONTRACTOR SHALL CONTACT COLUMBUS RECREATION & PARKS DEPARTMENT'S (CRPD) INSPECTOR, KEITH MAY, AT KAMAY@COLUMBUS.GOV THIRTY (30) CALENDAR DAYS PRIOR TO ANY WORK ON OR NEAR CRPD PROPERTY. THE CONTRACTOR SHALL SUBMIT A WORK SCHEDULE AND COORDINATE ACCESS WITH CRPD INSPECTOR PRIOR TO ANY WORK ON OR NEAR CRPD PROPERTY. SCHEDULED EVENTS BY CRPD SHALL TAKE PRECEDENCE OVER THE CONTRACTOR'S WORK SCHEDULE, AND THE CONTRACTOR SHALL ADJUST WORK SCHEDULE AS NECESSARY. THE CONTRACTOR SHALL NOT ENTER INTO A CRPD PROPERTY NOR STAGE/STORE ANY MATERIALS OR EQUIPMENT OUTSIDE THEIR WORK LIMITS ON CRPD PROPERTY WITHOUT A PERMIT ISSUED BY CRPD. THE PERMIT MUST BE POSTED ONSITE AT ALL TIMES. ANY AND ALL CRPD PARK AREAS DISTURBED BY THE CONTRACTOR DURING THE COURSE OF THEIR WORK ACTIVITIES SHALL BE RESTORED TO CONDITIONS THAT MEET OR EXCEED EXISTING CONDITIONS WITHIN THE TIME FRAMES NOTED IN THE APPROVED SCHEDULE AND SHALL BE TO THE SATISFACTION OF CRPD. UNLESS SPECIFIC PERMISSIONS ARE GRANTED BY CRPD, ACCESS TO, FROM, ON, OVER, UNDER, THROUGH, OR ACROSS CRPD PROPERTY IS NOT GRANTED OR IMPLIED. FAILURE TO HAVE A PERMIT IN PLACE THAT IS CONSISTENT WITH CRPD NPUP POLICY WILL RESULT IN DELAY OF FINAL SITE COMPLIANCE APPROVAL SIGNATURE BY RECREATION & PARKS.

**INDIANA BAT HABITAT PROTECTION NOTE**

FOR ANY TREES DESIGNATED FOR REMOVAL THAT MAY BE POTENTIAL BAT HABITAT AREAS, REMOVAL SHALL ONLY OCCUR FROM OCTOBER 1ST TO MARCH 31ST. IF THE CONTRACTOR PREFERS TO REMOVE THE TREES OUTSIDE OF THIS TIME FRAME, A SURVEY MUST BE CONDUCTED ACCORDING TO THE UNITED STATES FISH AND WILDLIFE SERVICES AND BY A BIOLOGIST WITH ALL REQUIRED FEDERAL AND/OR STATE COLLECTION PERMITS TO DETERMINE THE PRESENCE OF ANY INDIANA BATS. THE DATA COLLECTED DURING THE SURVEY MUST BE PROVIDED TO THE CITY FORESTRY SECTION AT (614) 724-1276 ACCORDING TO THE CONDITIONS OF THE PERMIT AND ANY REGULATORY AUTHORITY REQUIREMENTS. IF NO BATS ARE PRESENT THE TREE SHALL BE REMOVED WITHIN 24 HOURS OF THE SURVEY BEING CONDUCTED. IF BATS ARE FOUND TO BE PRESENT, THEN TREE SHALL REMAIN AND A PROTECTION AND ENHANCEMENT PLAN WILL BE REQUIRED.

**TREE PROTECTION NOTE**

A TREE PROTECTION PLAN WITH A DRAWING OF ANY WORK LOCATED WITHIN THE CRITICAL ROOT ZONE OF A PUBLIC TREE SHALL BE INCLUDED IN THE APPROVED FINAL SITE PLAN. REFER TO CRPD STANDARD DRAWING FOR TREE PROTECTION. CONSTRUCTION MATERIALS, EXCAVATION DEBRIS, FUEL, EQUIPMENT, OR VEHICLES ARE NOT TO BE STOCKPILED, STORED, DUMPED, OR PARKED WITHIN THE CRITICAL ROOT ZONE OF PUBLIC TREES. ALL TREES MUST BE PROTECTED AGAINST INJURY OR DAMAGE TO BRANCHES, TRUNKS, OR ROOTS FROM CONSTRUCTION AND EXCAVATION, AS DESCRIBED IN THE "BEST MANAGEMENT PRACTICES - MANAGING TREES DURING CONSTRUCTION" A COMPANION PUBLICATION TO ANSI A300 PART 5. IF THERE IS A QUESTION WHETHER A TREE OR NOT NEEDS TO BE PROTECTED, THE CONTRACTOR MUST CONTACT THE CITY FORESTRY SECTION AT (614) 724-1276. FAILURE TO CONTACT THE CITY FORESTRY REPRESENTATIVE IN ADVANCE OF CONSTRUCTION WILL RESULT IN THE CONTRACTOR REIMBURSING CITY FORESTRY FOR THE COST OF ANY AND ALL DAMAGE AS DETERMINED BY THE CURRENT ANSI A300/CITY OF COLUMBUS EXECUTIVE ORDER 2015-01 FOR TREE PROTECTION AND REPLACEMENT. A 1 YEAR WARRANTY IS REQUIRED FOR ALL PROTECTED TREES.

**TREE PRESERVATION NOTE**

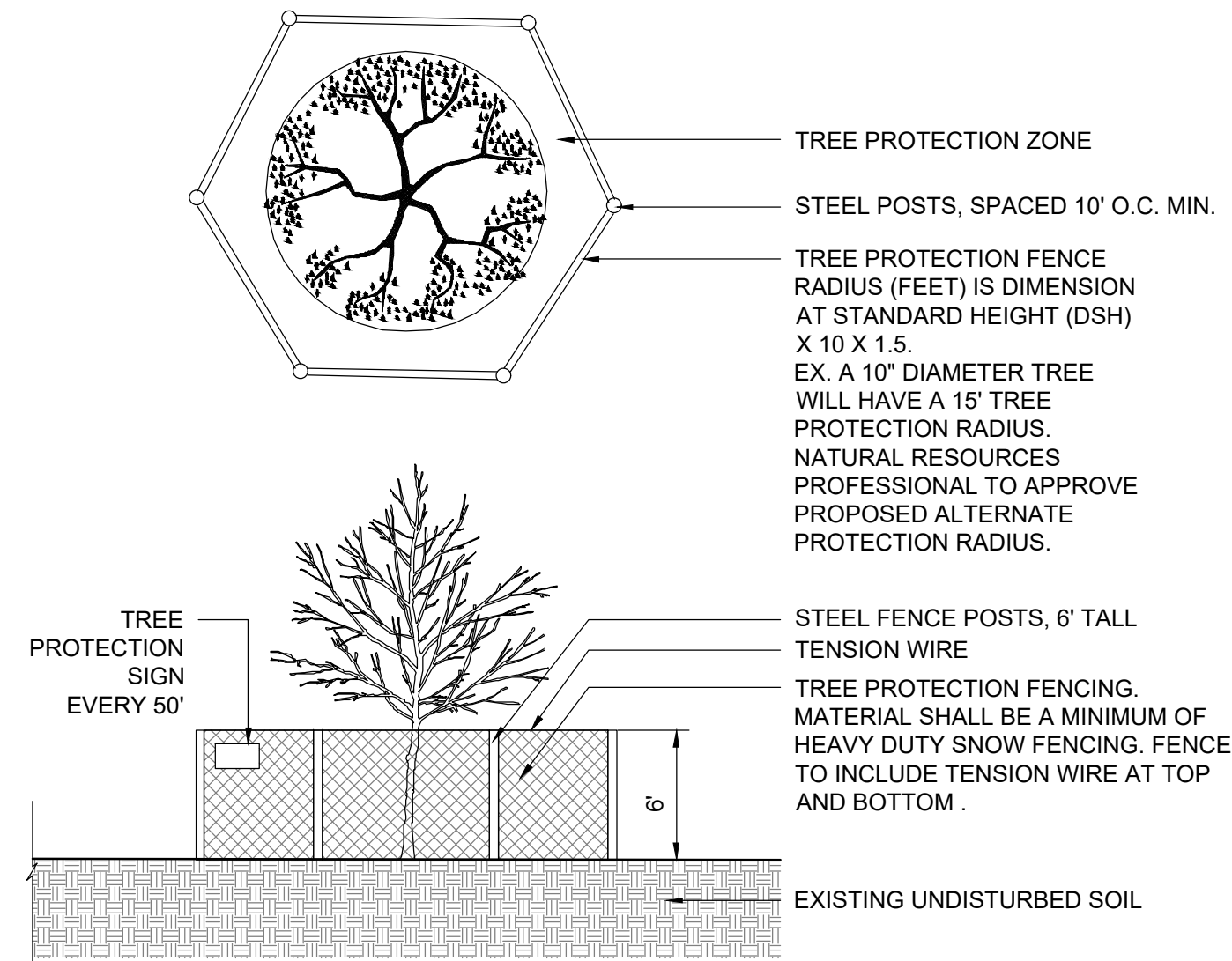
ALL PUBLIC TREES AND THE GROUND BELOW THEIR RESPECTIVE CRITICAL ROOT ZONES, WHETHER SHOWN OR NOT SHOWN ON THE PLANS, ARE TO BE PRESERVED UNLESS APPROVAL TO REMOVE OR PRUNE IS GIVEN IN WRITING BY COLUMBUS RECREATION & PARKS (CRPD)/CITY FORESTER OR IF THE PUBLIC TREE REMOVAL HAS BEEN DESIGNATED ON THE APPROVED FINAL SITE COMPLIANCE PLAN. TREES APPROVED FOR REMOVAL BY CRPD/CITY FORESTER SHALL BE PAID FOR UNDER CMSC ITEM 201, CLEARING AND GRUBBING, UNLESS OTHERWISE PROVIDED FOR BY UNIT PRICE BID UNDER ITEM 201. THE CONTRACTOR SHALL NOT ENCR OACH INTO THE CRITICAL ROOT ZONE OF ANY PUBLIC TREE DESIGNATED FOR PRESERVATION. ALL TREES REMOVED SHALL INCLUDE STUMP REMOVAL TO EIGHTEEN (18) INCHES BELOW GRADE. ALL CLEARING AND GRUBBING PERFORMED ON CRPD PROPERTY, RIGHT-OF-WAY, OR ANY CITY OF COLUMBUS PROPERTY SHALL BE REMOVED AND DISPOSED OF BY THE CONTRACTOR. HEAVY EQUIPMENT WILL NOT BE ALLOWED TO COMPACT THE SOIL OVER THE ROOT ZONE OF EXISTING PUBLIC TREES. RESTRICTED EQUIPMENT ACCESS ROUTES SHALL BE COORDINATED WITH CRPD INSPECTOR, KEITH MAY, AT KAMAY@COLUMBUS.GOV BEFORE WORK IS BEGINS. TEMPORARY PAVING MATERIALS, SUCH AS PLYWOOD, LUMBER OR RUBBER MATTING, SPREAD OVER THE ROOT ZONE OF PUBLIC TREES MAY BE REQUIRED TO PREVENT COMPACTION. IF A PUBLIC TREE NEEDS TO BE REMOVED, THE CONTRACTOR SHALL PROVIDE A TREE MITIGATION PLAN TO THE CITY FORESTRY SECTION ((614) 724-1276) AND REFER TO THE CRPD TREE MITIGATION PLAN GUIDANCE, ANSI A300.

**GREENWAY TRAIL NOTE**

ALL ACTIVITIES THAT MAY BE ADJACENT TO/DISTURB A COLUMBUS RECREATION & PARKS DEPARTMENT (CRPD) TRAIL, AND/OR HAVE ANY IMPACTS TO NORMAL TRAIL FLOW REQUIRE COORDINATION WITH KELLY MESSER WITH CRPD AT KNMESSER@COLUMBUS.GOV THIRTY (30) CALENDAR DAYS PRIOR TO ANY WORK COMMENCING FOR ONSITE COORDINATION, ONSITE MEETING, SIGNAGE, TRAFFIC CONTROL DETOUR PLAN, RESTORATION PLAN, DISTURBANCE AND/OR CLEARING LIMIT REVIEW. ACCESS OR USE OF GREENWAY TRAILS FOR ANY NON-PARK USE IS NOT GRANTED OR IMPLIED UNLESS SPECIFIC PERMISSIONS ARE GRANTED IN WRITING FROM CRPD. THE CONTRACTOR SHALL SUBMIT A VEHICLE/EQUIPMENT TRAFFIC PLAN INCLUDING IDENTIFICATION NUMBERS, TYPE OF VEHICLE/EQUIPMENT, AND WEIGHT OF VEHICLE/EQUIPMENT TO BE USED PRIOR TO THE START OF WORK. ONLY VEHICLES/EQUIPMENT APPROVED BY CRPD IN WRITING SHALL BE PERMITTED ON THE TRAIL. ADDITIONALLY, EXISTING TRAIL CONDITIONS MUST BE DOCUMENTED THROUGH PICTURES OR VIDEO BEFORE WORK BEGINS. IF THE TRAIL IS DAMAGED BY CONTRACTOR USE, THE CONTRACTOR MUST REPAIR THE TRAIL BACK TO CONDITIONS THAT MEET OR EXCEED EXISTING CONDITIONS.

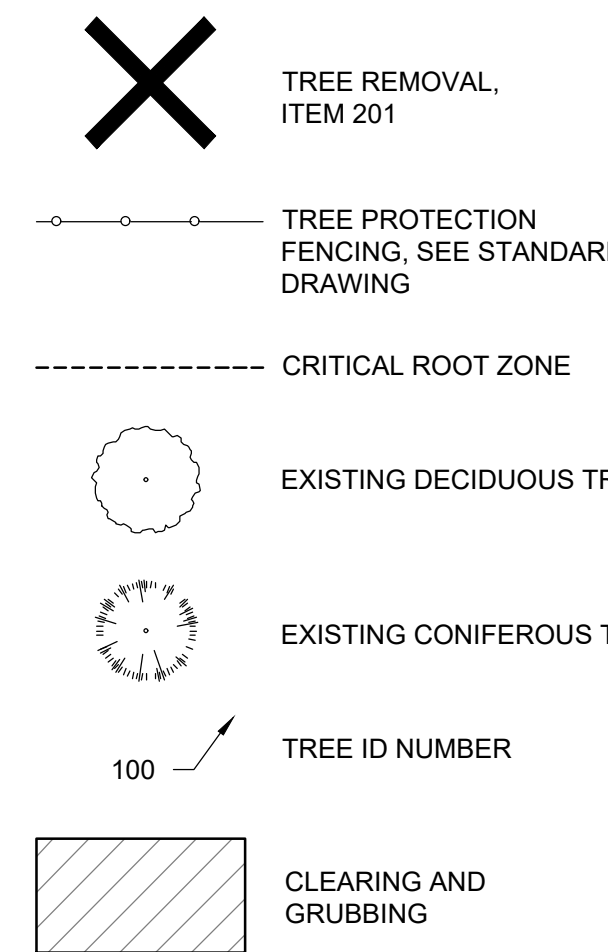
**GENERAL NOTES:**

- FOR GROUPS OF TREES PLACE BARRICADES BETWEEN TREES AND CONSTRUCTION ACTIVITY AT THE EDGE OF THE TREES CRITICAL ROOT ZONE.
- TREE PROTECTION IS REQUIRED WHEN CONSTRUCTION ACTIVITY ENCR OACHES ON THE CRITICAL ROOT ZONE OF A TREE.
- SEE COLUMBUS TREE TECHNICAL MANUAL FOR ADDITIONAL TREE PROTECTION REQUIREMENTS.

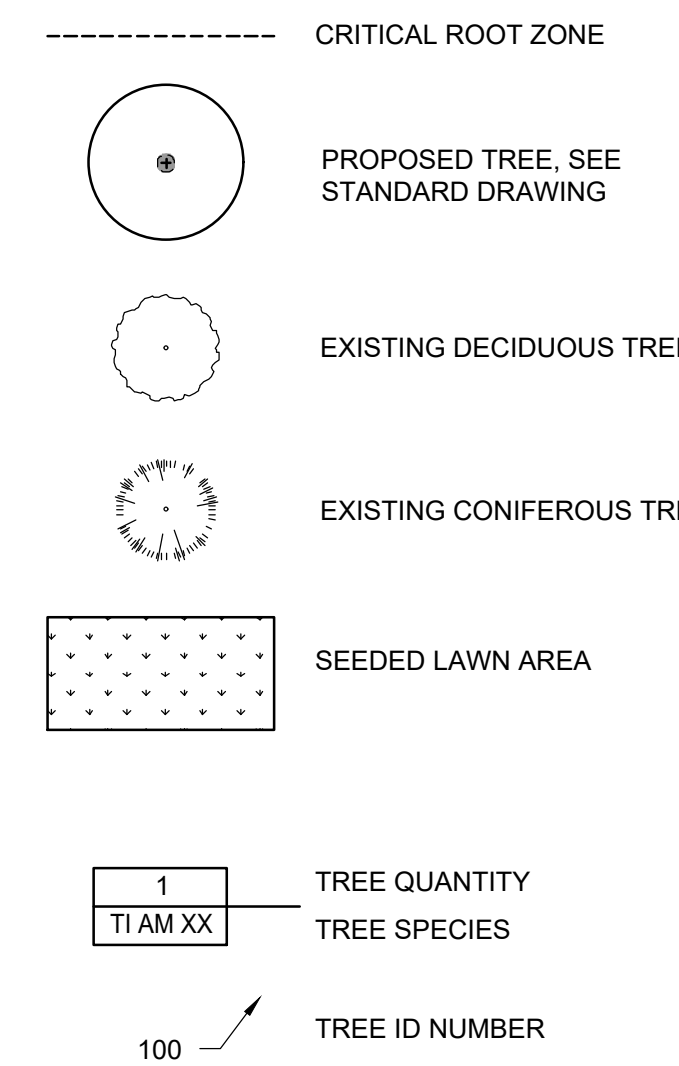


**1 TREE PROTECTION**

**TREE PROTECTION AND REMOVAL LEGEND**

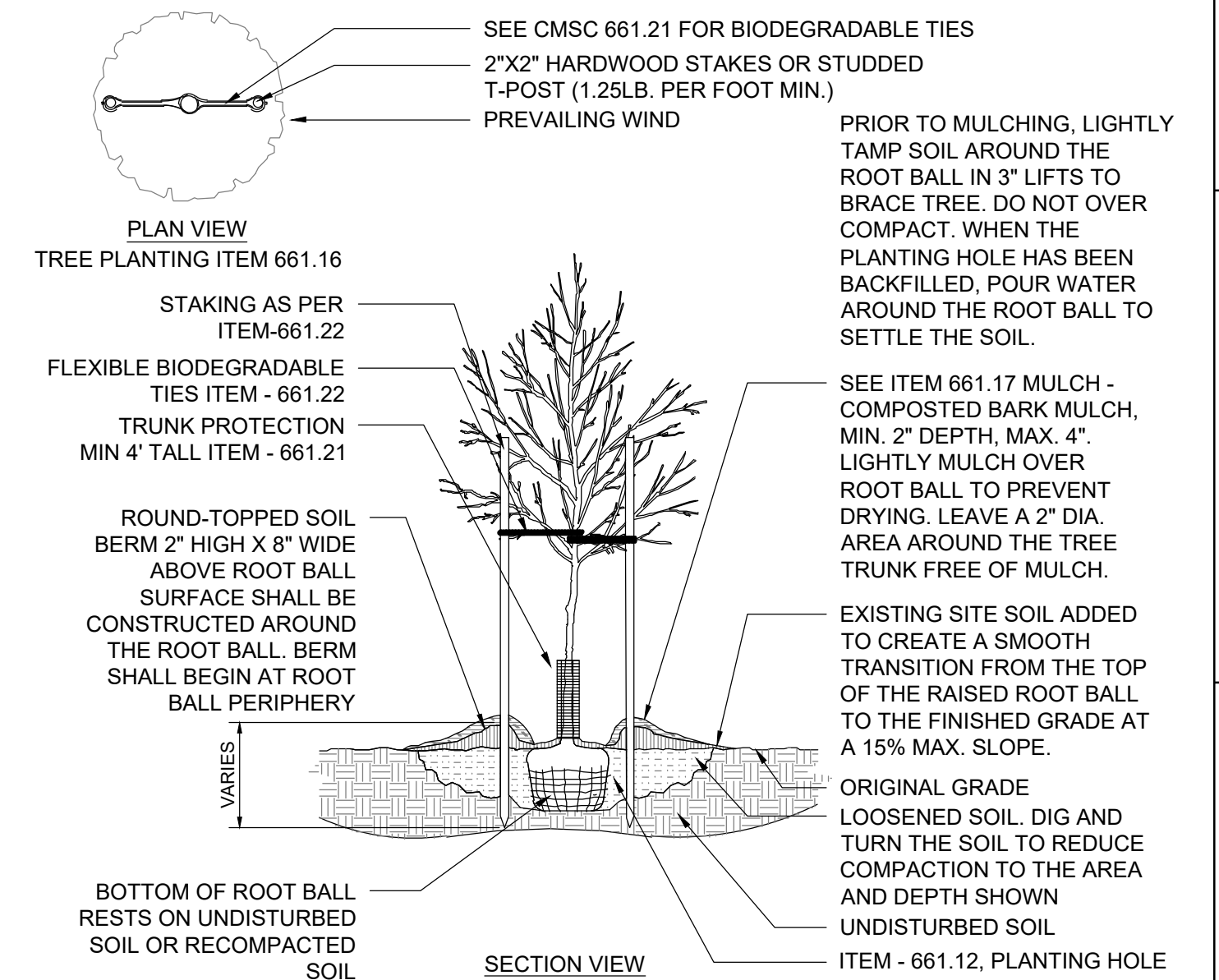


**PLANTING LEGEND**



**GENERAL NOTES:**

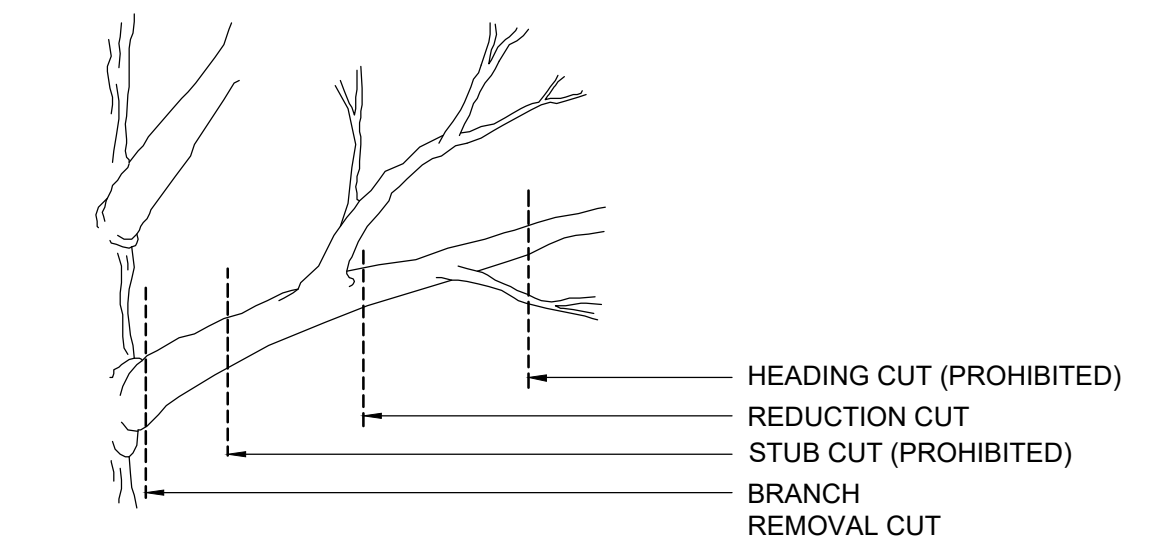
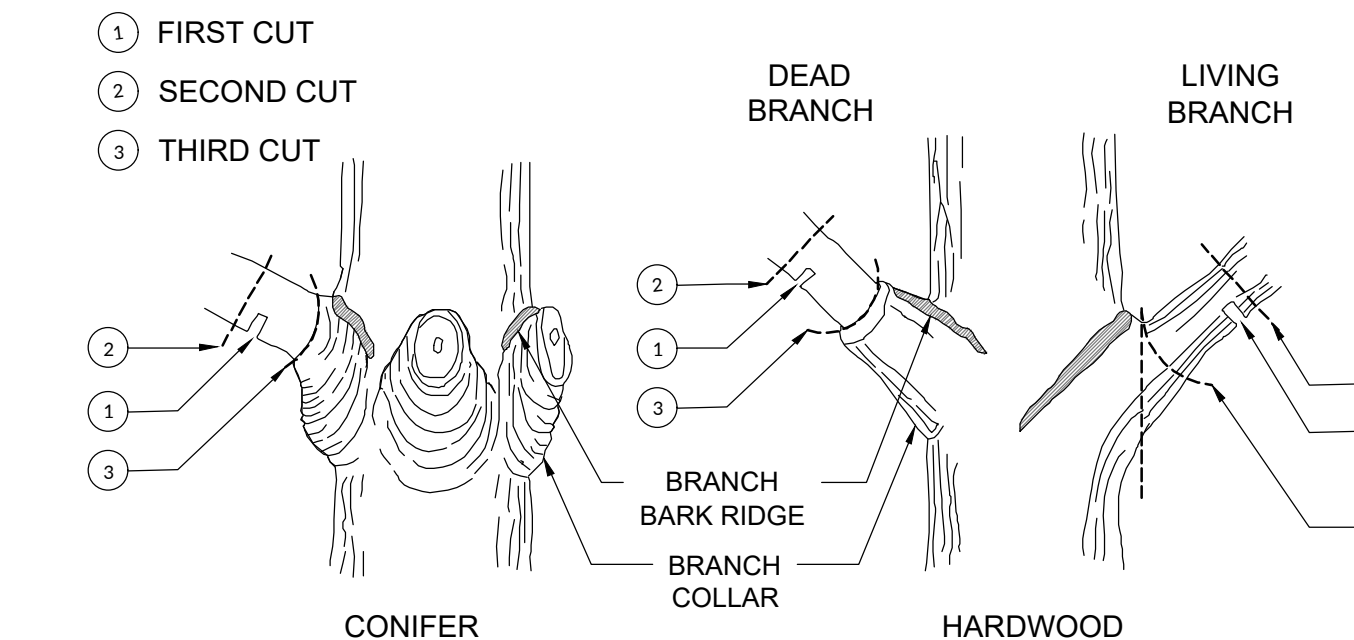
- REMOVE DEAD AND BROKEN BRANCHES AND ALL SUCKER GROWTH. DO NOT DAMAGE OR REMOVE CENTRAL LEADER.
- THE TYPE OF TREES TO BE USED SHALL BE SELECTED FROM AN APPROVED LIST PROVIDED BY THE CITY, REFERENCE TREE MANUAL.
- SEE SCD 2179 BACKFILL WITHIN THE RIGHT-OF-WAY.



**2 TREE PLANTING**

**GENERAL NOTES:**

- PROTECT BRANCH COLLAR WHEN PRUNING.
- DO NOT LEAVE STUB
- DO NOT FLUSH CUT AGAINST TRUNK.
- CLIMBING IRONS OR SPIKES SHALL NOT BE USED ON ANY TREE THAT IS SCHEDULED FOR PRUNING. TREES SHALL BE RAISED NO MORE THAN 1/3 THE HEIGHT OF THE TREE, EXCEPTIONS WITH APPROVAL OF THE RECREATION AND PARKS DEPARTMENT FORESTRY SECTION.



**3 TREE PRUNING TECHNIQUE**

PUBLIC TREE PLAN #

PROJECT OWNER  
COLUMBUS RECREATION AND PARKS DEPARTMENT  
1500 Columbus Ave  
Columbus, OH 43206

PROJECT ADDRESS  
XXXXX  
XXXXXX

SHEET TITLE  
**GENERAL NOTES**

SHEET NUMBER  
**G001**

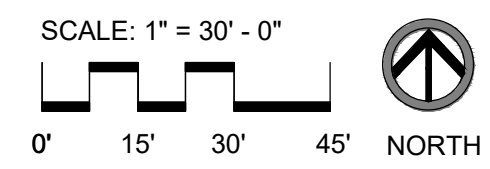
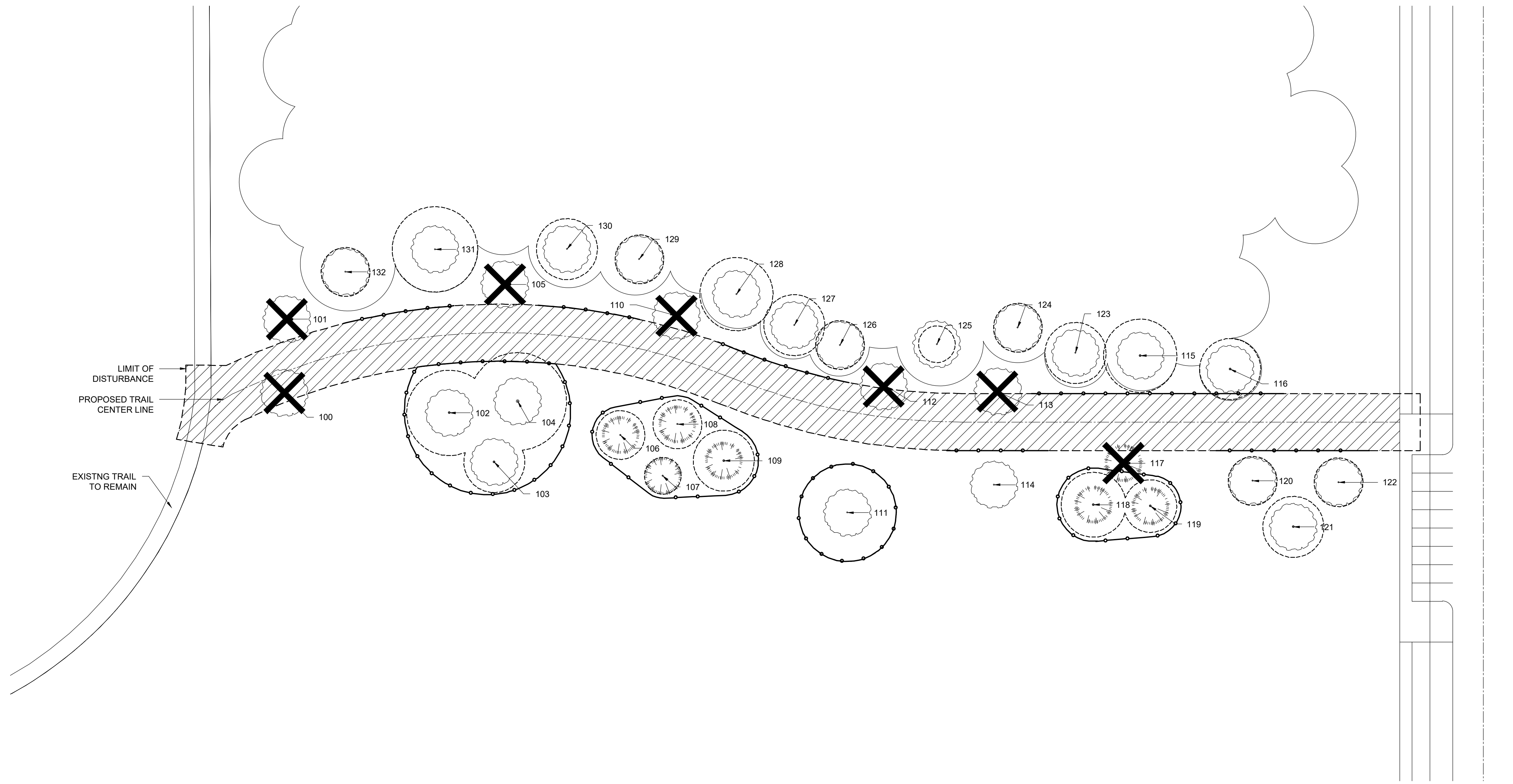
TABLE 1 - EXISTING TREE DATA TABLE											
TREE TAG NUMBER	CRPD TREE ID DATABASE NUMBER	BOTANICAL NAME	COMMON NAME	DSH (Diameter at Standard Height)	CONDITION	CRITICAL ROOT ZONE (Radius)	ACTION	MITIGATION REQUIRED (Y/N)	OTHER NOTES (Reason for Removal)	PROTECTION MEASURES	SHEET NUMBER
<b>Protected Trees</b>											
102	#####	Quercus alba	White Oak	14"	GOOD	21'	DO NOT DISTURB	N		CHAIN LINK FENCING	L002
103	#####	Quercus alba	White Oak	10"	GOOD	15'	DO NOT DISTURB	N		CHAIN LINK FENCING	L002
104	#####	Quercus alba	White Oak	16"	POOR	24'	DO NOT DISTURB	N		CHAIN LINK FENCING	L002
106	#####	Pinus strobus	White Pine	8"	GOOD	12'	DO NOT DISTURB	N		CHAIN LINK FENCING	L002
107	#####	Pinus strobus	White Pine	6"	POOR	9'	DO NOT DISTURB	N		CHAIN LINK FENCING	L002
108	#####	Pinus strobus	White Pine	8"	GOOD	12'	DO NOT DISTURB	N		CHAIN LINK FENCING	L002
109	#####	Pinus strobus	White Pine	10"	GOOD	15'	DO NOT DISTURB	N		CHAIN LINK FENCING	L002
111	#####	Quercus alba	White Oak	16"	FAIR	24'	DO NOT DISTURB	N		CHAIN LINK FENCING	L002
114	#####	Quercus rubrum	Red Oak	10"	POOR	15'	DO NOT DISTURB	N		CHAIN LINK FENCING	L002
115	#####	Quercus rubrum	Red Oak	12"	FAIR	18'	DO NOT DISTURB	N		CHAIN LINK FENCING	L002
116	#####	Quercus alba	White Oak	14"	GOOD	21'	DO NOT DISTURB	N		CHAIN LINK FENCING	L002
118	#####	Pinus strobus	White Pine	8"	POOR	12'	DO NOT DISTURB	N		CHAIN LINK FENCING	L002
119	#####	Pinus strobus	White Pine	12"	FAIR	18'	DO NOT DISTURB	N		CHAIN LINK FENCING	L002
120	#####	Acer rubrum	Red Maple	10"	GOOD	15'	DO NOT DISTURB	N		CHAIN LINK FENCING	L002
121	#####	Acer rubrum	Red Maple	8"	POOR	12'	DO NOT DISTURB	N		CHAIN LINK FENCING	L002
122	#####	Acer rubrum	Red Maple	10"	GOOD	15'	DO NOT DISTURB	N		CHAIN LINK FENCING	L002
123	#####	Acer rubrum	Red Maple	8"	GOOD	12'	DO NOT DISTURB	N		SNOW FENCING	L002
124	#####	Ulmus americana	American Elm	8"	GOOD	12'	DO NOT DISTURB	N		SNOW FENCING	L002
125	#####	Ulmus americana	American Elm	6"	GOOD	9'	DO NOT DISTURB	N		SNOW FENCING	L002
126	#####	Acer rubrum	Red Maple	8"	FAIR	12'	DO NOT DISTURB	N		SNOW FENCING	L002
127	#####	Quercus rubrum	Red Oak	10"	GOOD	15'	DO NOT DISTURB	N		SNOW FENCING	L002
128	#####	Quercus rubrum	Red Oak	12"	FAIR	18'	DO NOT DISTURB	N		SNOW FENCING	L002
129	#####	Quercus alba	White Oak	8"	GOOD	12'	DO NOT DISTURB	N		SNOW FENCING	L002
130	#####	Quercus alba	White Oak	10"	GOOD	15'	DO NOT DISTURB	N		SNOW FENCING	L002
131	#####	Ulmus americana	American Elm	14"	FAIR	21'	DO NOT DISTURB	N		SNOW FENCING	L002
132	#####	Acer rubrum	Red Maple	8"	FAIR	12'	DO NOT DISTURB	N		SNOW FENCING	L002
<b>Removed Trees</b>											
100	#####	Acer rubrum	Red Maple	8"	POOR	12'	TO BE REMOVED	Y	Less than fair condition and path interference		L002
101	#####	Acer rubrum	Red Maple	6"	DEAD	9'	TO BE REMOVED	N	Dead Tree and path interference		L002
105	#####	Quercus alba	White Oak	6"	FAIR	9'	TO BE REMOVED	Y	Path interference		L002
110	#####	Quercus alba	White Oak	8"	POOR	12'	TO BE REMOVED	Y	Less than fair condition and path interference		L002
112	#####	Acer rubrum	Red Maple	6"	GOOD	9'	TO BE REMOVED	Y	Path interference		L002
113	#####	Acer rubrum	Red Maple	8"	GOOD	12'	TO BE REMOVED	Y	Less than fair condition and path interference		L002
117	#####	Ailanthus altissima	Tree of Heaven	10"	GOOD	15'	TO BE REMOVED	N	Invasive in natural area, path interference		L002
<b>ITEM 1 - TOTAL REMOVED INCHES:</b>				<b>52"</b>							
<b>ITEM 2 - TOTAL INCHES TO BE MITIGATED</b>				<b>46"</b>							

TABLE 2 - PROPOSED TREE DATA TABLE							
KEY	QTY	SIZE	BOTANICAL NAME	COMMON NAME	STOCK	TOTAL INCHES	SHEET NUMBER
<b>TREES</b>							
AC SA CO	5	3" CALIPER	ACER SACCHARUM 'COMMEMORATION'	COMMEMORATION SUGAR MAPLE	B&B	15"	L003
GY DI ES	5	3" CALIPER	GYMNOCLADUS DIOICUS 'ESPRESSO'	ESPRESSO KENTUCKY COFFEE TREE	B&B	15"	L003
QU BI XX	5	2" CALIPER	QUERCUS BICOLOR	SWAMP WHITE OAK	B&B	10"	L003
<b>TOTAL:</b>	<b>15</b>					<b>ITEM 2 - TOTAL INCHES TO BE MITIGATED: 46"</b>	
						<b>ITEM 3 - TOTAL INCHES PROVIDED: 40"</b>	
						<b>TREE FUND PAYMENT (ITEM 2 - ITEM 3) * \$260:</b>	<b>\$1560</b>


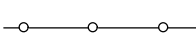
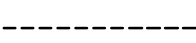


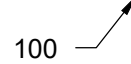

TABLE 3 - STANDARD PAY ITEMS					
ITEM NUMBER	DESCRIPTION	UNIT	QTY.	SHEET NUMBER	
201.03	Clearing & Grubbing	SF	17,527	L002	
655	Tree Protection Fencing	LF	888	L002	
209.01	Linear Grading	LF	600	L002	
655.05	Tree Removal	LF	7	L002	
661	Tree Planting	QTY.	15	L003	

PUBLIC TREE PLAN #

PROJECT OWNER  
COLUMBUS RECREATION AND PARKS DEPARTMENT  
Columbus, OH 43206PROJECT ADDRESS  
XXXXX  
XXXXXXSHEET TITLE  
TREE DATA TABLESHEET NUMBER  
L001



**TREE PROTECTION AND REMOVAL LEGEND**

-  TREE REMOVAL, ITEM 201
-  TREE PROTECTION FENCING, SEE STANDARD DRAWING
-  CRITICAL ROOT ZONE
-  EXISTING DECIDUOUS TREE
-  EXISTING CONIFEROUS TREE
-  TREE ID NUMBER
-  CLEARING AND GRUBBING

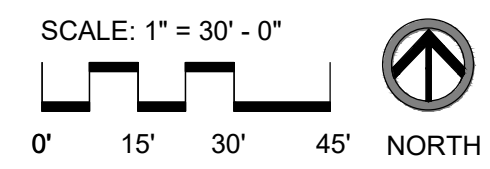
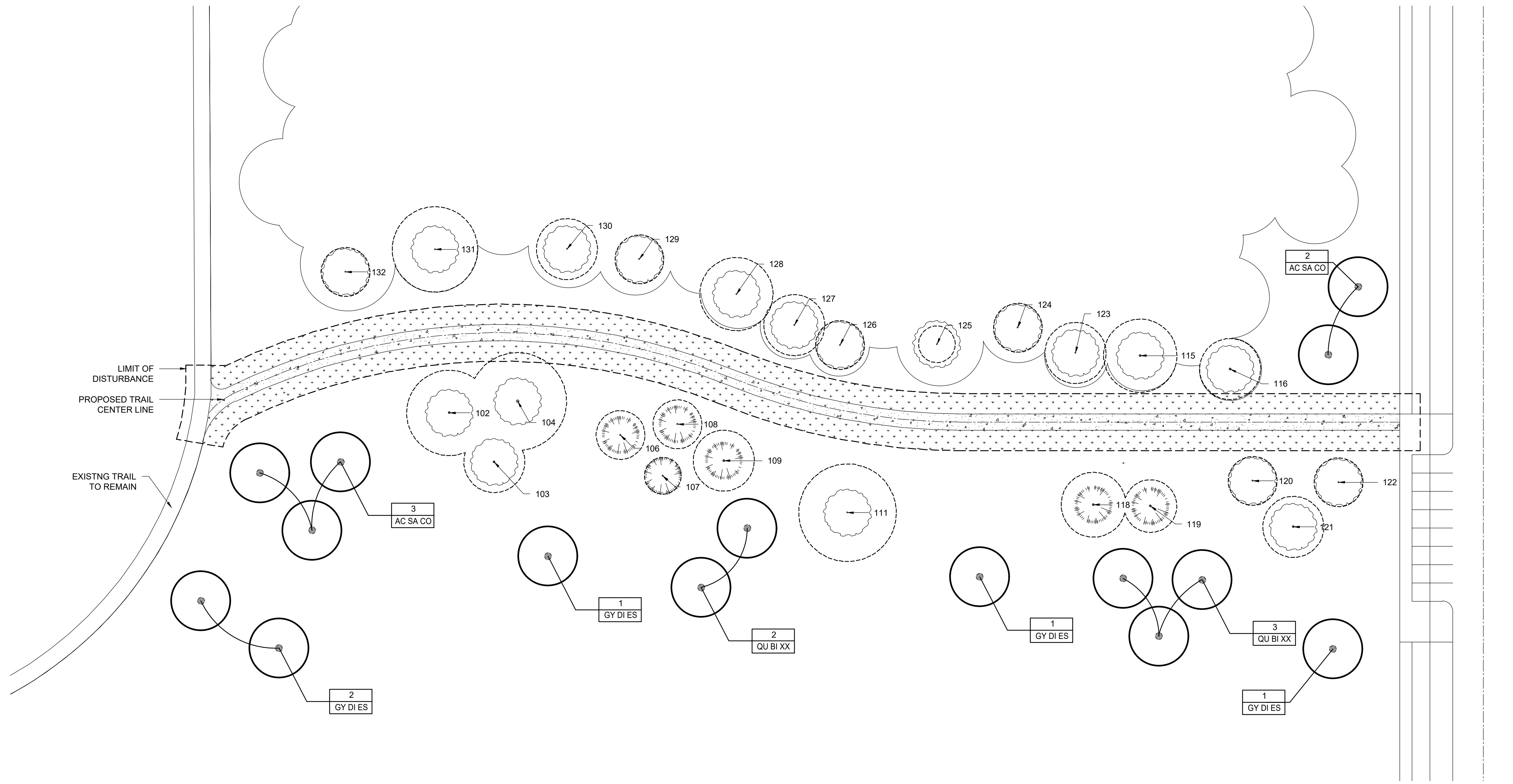
PUBLIC TREE PLAN #

PROJECT OWNER  
**COLUMBUS RECREATION AND PARKS DEPARTMENT**  
 Columbus, OH 43206

PROJECT ADDRESS  
 XXXXX  
 XXXXXX

SHEET TITLE  
**DEMOLITION PLAN**

SHEET NUMBER  
**L002**



**PLANTING LEGEND**

- CRITICAL ROOT ZONE
- PROPOSED TREE, SEE STANDARD DRAWING
- EXISTING DECIDUOUS TREE
- EXISTING CONIFEROUS TREE
- SEEDED LAWN AREA

SHEET NUMBER	L003
SHEET TITLE	TREE PLAN
PROJECT ADDRESS	XXXXX XXXXXX
PROJECT OWNER	COLUMBUS RECREATION AND PARKS DEPARTMENT Columbus, OH 43206
PUBLIC TREE PLAN #	